

# SPIROTECH SPECIFICATION SHEET



Product: SpiroCombi Demountable  
DN150 Weld end

Type:  
Date:

BD150L  
11/19/2019

Customer:

Project:

Reference:

## Design criteria

|                     |                          |                   |
|---------------------|--------------------------|-------------------|
| Medium:             | Water / glycol (max 50%) |                   |
| Nom. flow velocity: | 1.5                      | m/s               |
| Nom. flow rate:     | 108.0                    | m <sup>3</sup> /h |
| Max. pressure:      | 10                       | bar-g             |
| Max. temperature:   | 110                      | °C                |
| Δp at nom. flow:    | 4.1                      | kPa               |
| Design standard:    | EN 13445                 |                   |

## Testing and quality assurance

|   |     |
|---|-----|
| Test pressure (bar):                      | 7   |
| Test medium:                              | Air |
| Test certificate:                         | no  |
| Design and manufacturing acc. 2014/68/EU: | yes |
| Material certificates (structural parts): | no  |
| Drawing:                                  | no  |
| Weld procedures:                          | no  |
| Nondestructive Testing (X-ray: 10%):      | no  |
| Notified body inspection:                 | no  |

## Construction materials

|                      |                    |
|----------------------|--------------------|
| Body:                | S235 JR G2 (St.37) |
| Connections:         | S235 JR G2 (St.37) |
| Fittings:            | S235 JR G2 (St.37) |
| Flanges demountable: | P250GH             |
| Flange packing:      | Novapress 815      |
| Heads:               | S235 JR G2 (St.37) |
| Deaeration cap:      | Brass              |
| Valve sealing:       | Viton              |
| Float:               | PP                 |
| Spirotube Tube:      | S235 JR G2 (St.37) |
| Spirotube Wire:      | Copper             |
| Spirotube Solder:    | Tin(SnCu3)         |
| Paint:               | Standard           |
| Color:               | Yellow (RAL 1003)  |
| Drain valve:         | Nickeled brass     |

## Drawing

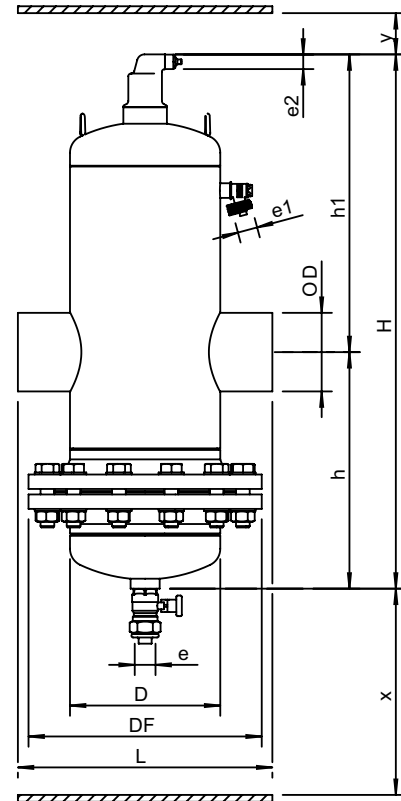

## Dimensions

|                      |          |
|----------------------|----------|
| DN:                  | 150      |
| OD:                  | 168.3 mm |
| H:                   | 1035 mm  |
| h:                   | 475 mm   |
| h1:                  | 560 mm   |
| D:                   | 324 mm   |
| DF:                  | 460 mm   |
| L:                   | 525 mm   |
| e:                   | Rp1      |
| e1:                  | G3/4     |
| e2:                  | R1/2     |
| x:                   | >920 mm  |
| y:                   | >50 mm   |
| Volume:              | 75 ltr   |
| Dry weight (approx): | 110 kg   |

Subject to changes